

SHIP ACCOMMODATION

MARINE INTERIOR DOOR

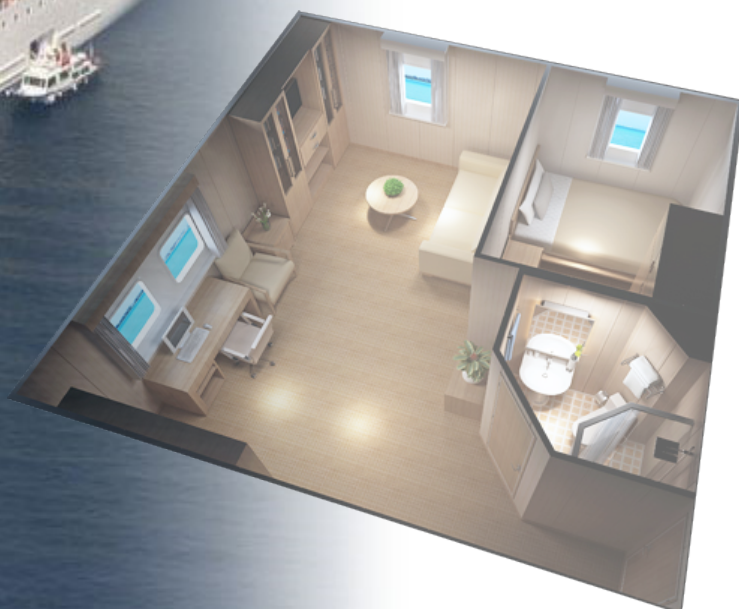

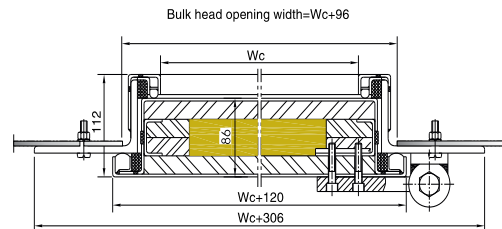
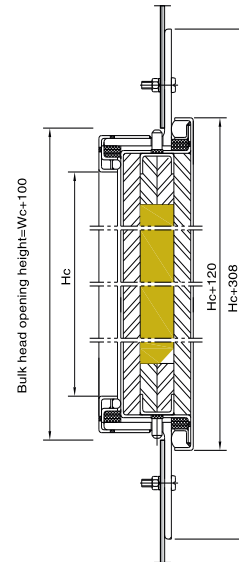

H120

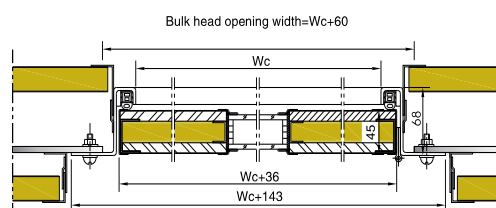
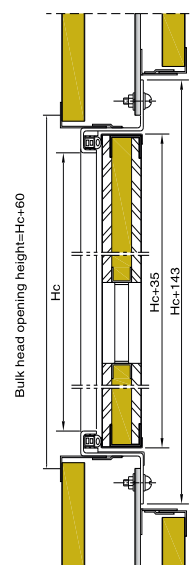
Technical Specification

Door Leaf:	3mm steel plate,baked paint
Door Frame:	8mm steel sheet
	Stainless steel sill cover plate
	Baked paint
Thickness of door leaf:	86mm

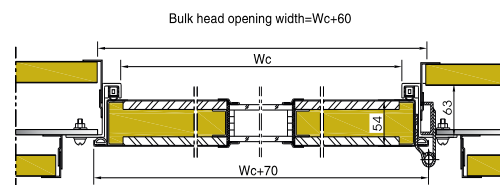
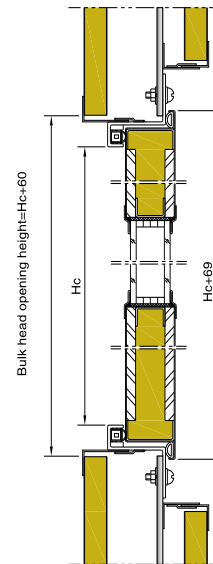
A-60

Technical Specification	
Door Leaf:	0.6mm PVC-laminated galvanized steel sheet with protective foil
Door Frame:	3mm steel sheet
	Stainless steel sill cover plate
	Baked paint
Thickness of door leaf:	45mm

A-60

Technical Specification

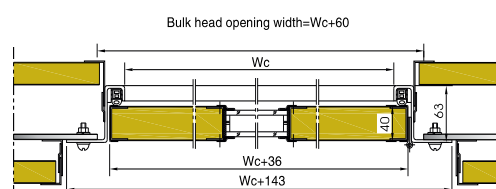
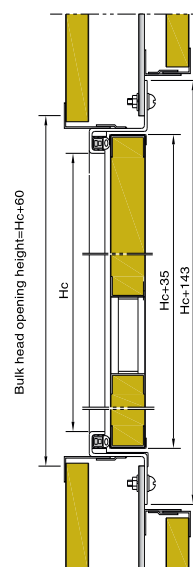
Door Leaf:	1mm galvanized steel sheet, baked paint
Door Frame:	3mm steel sheet
	Stainless steel sill cover plate
	Baked paint
Thickness of door leaf:	54mm

A-15

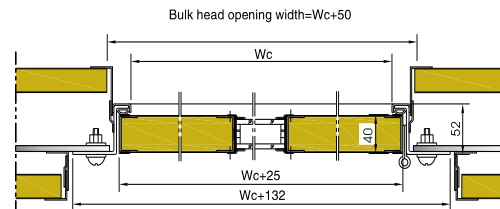
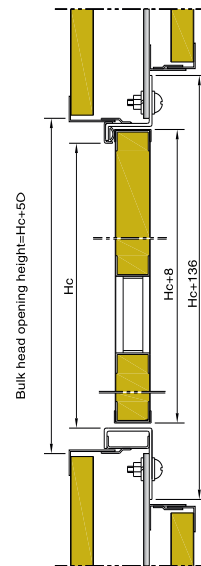
Technical Specification	
Door Leaf:	0.6mm PVC-laminated galvanized steel sheet with protective foil
Door Frame:	3mm steel sheet
	Stainless steel sill cover plate
	Baked paint
Thickness of door leaf:	40mm

B-15

Technical Specification

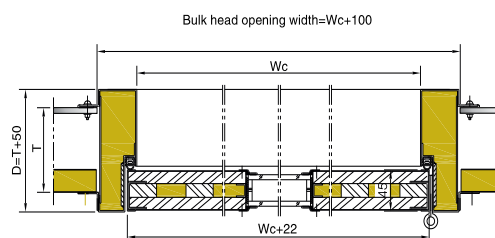
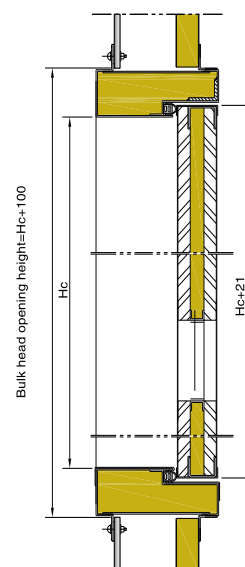
Door Leaf:	0.6mm PVC-laminated galvanized steel sheet with protective foil
Door Frame:	3mm steel sheet
	Stainless steel sill cover plate
	Baked paint
Thickness of door leaf:	40mm

A-60

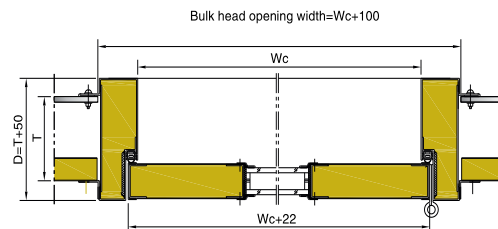
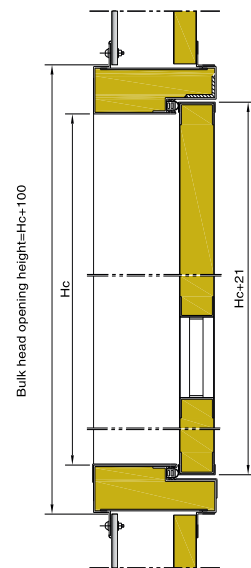
Technical Specification	
Door Leaf:	0.6mm PVC-laminated galvanized steel sheet with protective foil
Door Frame:	1.5mm steel sheet
	Stainless steel sill cover plate
	Baked paint
Thickness of door leaf:	45mm
" T " is decoration thickness	
" D " is door frame thickness	

A-15

Technical Specification

Door Leaf:	0.6mm PVC-laminated galvanized steel sheet with protective foil
Door Frame:	1.5mm steel sheet
	Stainless steel sill cover plate
	Baked paint
Thickness of door leaf:	40mm

" T " is decoration thickness

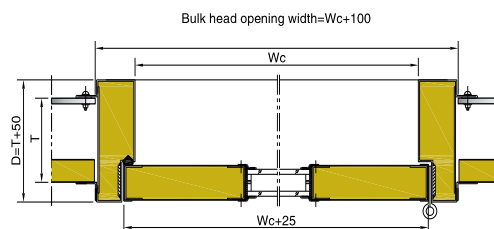
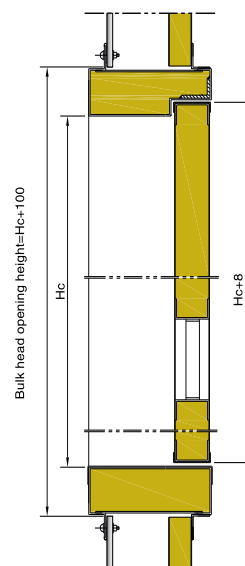
" D " is door frame thickness

B-15

Technical Specification	
Door Leaf:	0.6mm PVC-laminated galvanized steel sheet with protective foil
Door Frame:	1.5mm steel sheet
	Stainless steel sill cover plate
	Baked paint
Thickness of door leaf:	40mm
" T " is decoration thickness	
" D " is door frame thickness	

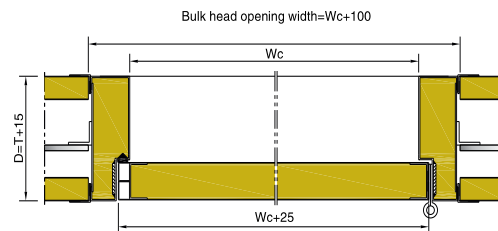
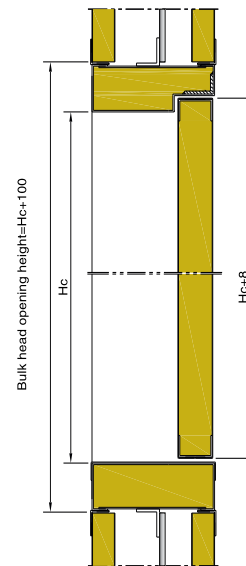
B-15

Technical Specification

Door Leaf:	0.6mm PVC-laminated galvanized steel sheet with protective foil
Door Frame:	1.5mm steel sheet
	Stainless steel sill cover plate
	Baked paint
Thickness of door leaf:	40mm

" T " is decoration thickness

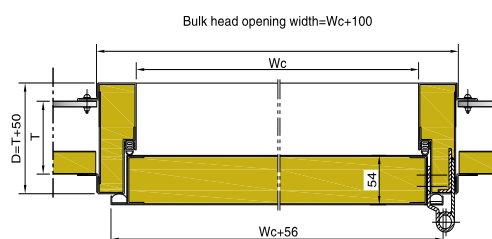
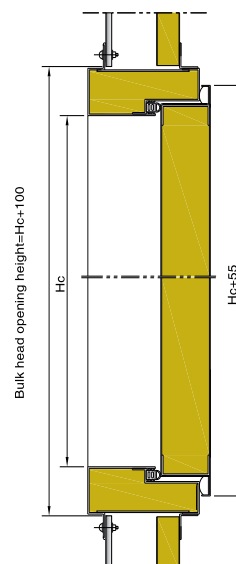
" D " is door frame thickness

B-15/B-30

Technical Specification	
Door Leaf:	1mm galvanized steel sheet,baked pain.
Door Frame:	1.5mm steel sheet
	Stainless steel sill cover plate
	Baked paint
Thickness of door leaf:	54mm
" T " is decoration thickness	
" D " is door frame thickness	

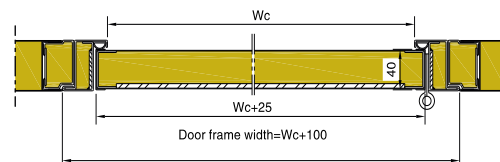
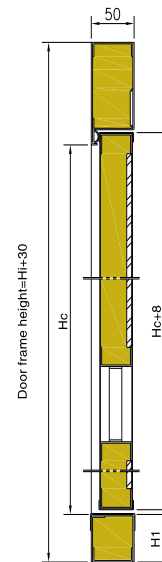
B-30

Technical Specification

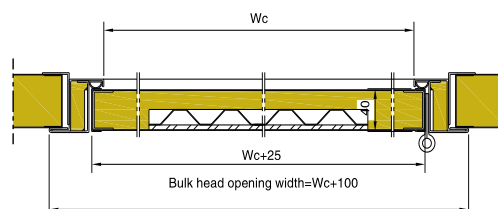
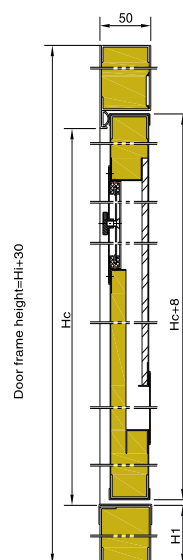
Door Leaf:	0.6mm PVC-laminated galvanized steel sheet with protective foil
Door Frame:	1.5mm steel sheet
	Stainless steel sill cover plate
	Baked paint
Thickness of door leaf:	40mm

B-15

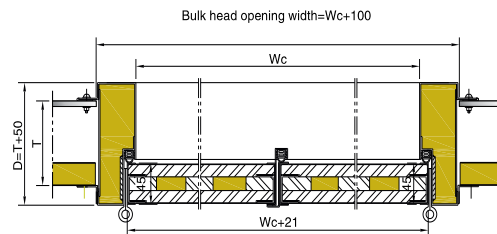
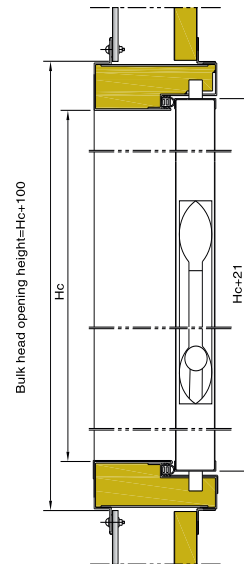
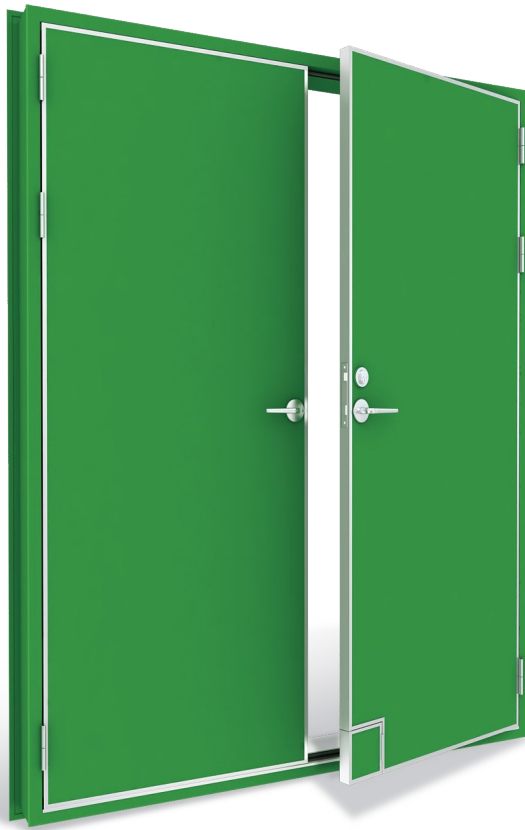
Technical Specification	
Door Leaf:	0.6mm PVC-laminated galvanized steel sheet with protective foil
Door Frame:	1.5mm steel sheet
	Stainless steel sill cover plate
	Baked paint
Thickness of door leaf:	40mm

A-60

Technical Specification

Door Leaf:	0.6mm PVC-laminated galvanized steel sheet with protective foil
Door Frame:	1.5mm steel sheet
	Stainless steel sill cover plate
	Baked paint
Thickness of door leaf:	45mm

" T " is decoration thickness

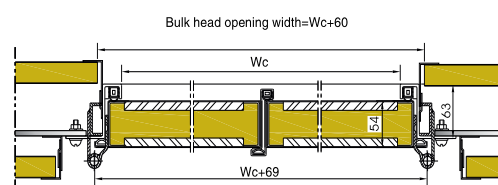
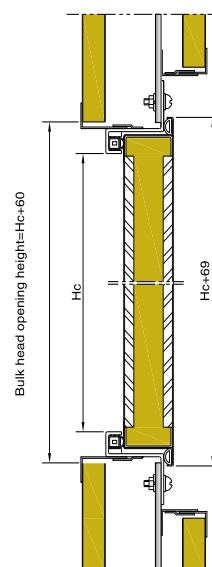
" D " is door frame thickness

A-60

Technical Specification	
Door Leaf:	1mm galvanized steel sheet,baked paint
Door Frame:	3mm steel sheet
	Stainless steel sill cover plate
	Baked paint
Thickness of door leaf:	54mm

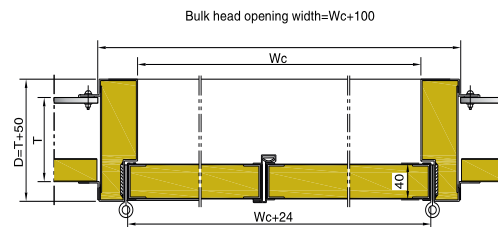
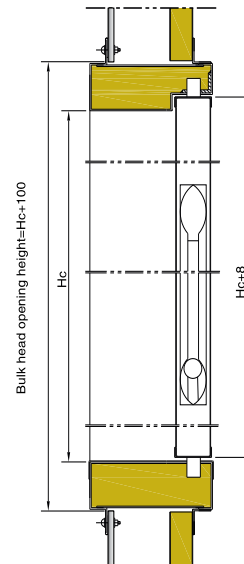
B-15

Technical Specification

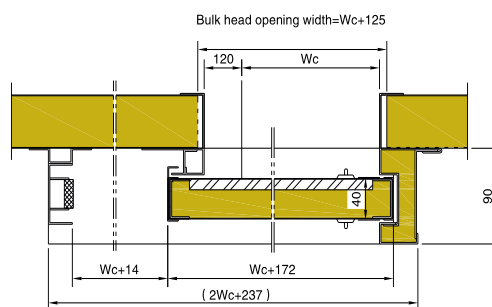
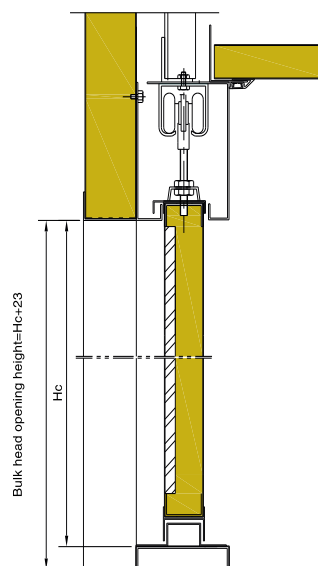
Door Leaf:	0.6mm PVC-laminated galvanized steel sheet with protective foil
Door Frame:	1.5mm steel sheet
	Stainless steel sill cover plate
	Baked paint
Thickness of door leaf:	40mm
" T " is decoration thickness	
" D " is frame thickness	

B-30

Technical Specification	
Door Leaf:	0.6mm PVC-laminated galvanized steel sheet with protective foil
Door Frame:	1.5mm steel sheet
	Stainless steel sill cover plate
	Baked paint
Thickness of door leaf:	40mm



ACCESS DOOR



For wall panel



Technical specification

Class	Max clear size(Wc x Hc)
B-15	500 x 2050
C	Provided by the client

For ceiling

Technical specification

Class	Max clear size(Wc x Hc)
B-15	450 x 600
C	Provided by the client



STAINLESS STEEL LOCK
C-1 type lock

Door thickness 35 ~ 45mm

C-4 type lock

Door thickness 35 ~ 45mm

C-5 type lock

Door thickness 35 ~ 45mm

Handle type

Door thickness 35~45mm

**MASTER KEY SYSTEM**

(2-level cross generation master key system)

(GRAND MASTER KEY)
(KEY 6 EA)

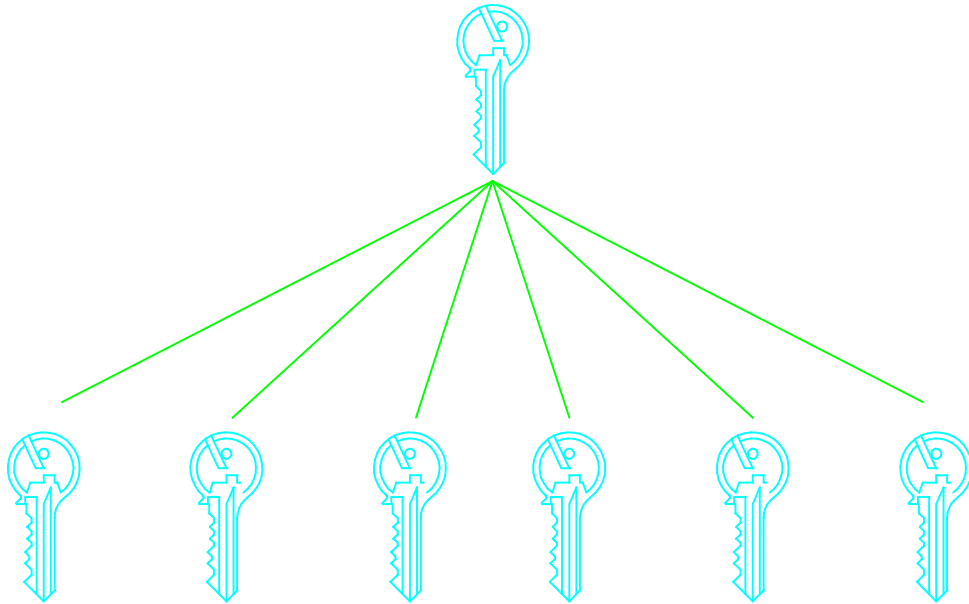

Submaster Key
(KEY 3 EA)